



CIHR Canadian National Brain Bee

Funded Nationally by CIHR-INMHA

Hosted by
Department of Psychology, Neuroscience & Behaviour
Faculty of Science, McMaster University

May 27 – 28, 2015

Welcome!

- We welcome you to the Ninth Annual CIHR Canadian National Brain Bee (CCNBB) and hope that you will enjoy your stay at McMaster University!
- Our first event on Friday will be tours of the laboratories in the Department of Psychology, Neuroscience & Behaviour beginning at 4pm. We expect to finish the competition on Saturday by 4:30pm. If you have questions about anything, please do not hesitate to contact us!
 - Esther Manoian (event coordinator): esther@mcmaster.ca Mobile: 905-807-8267
 - Tyler Pollock (grad student coordinator): polloctj@mcmaster.ca Mobile: 289-441-6198
 - Dr. Ayesha Khan (faculty coordinator): akhan@mcmaster.ca
 - Dr. Judith Shedden (chair): judith.shedden@gmail.com Mobile: 905-902-4096

Release Forms

- There are two release forms that we need you to sign. One is a permission form and the other is a photo release form. They can be found on our web site. Please print and sign the forms and bring them with you to the competition: <http://brainbee.ca/students/preparing-for-the-national/>

Accommodations

- Competitors and other guests will stay in Les Prince Residences. You can read about this residence (built in 2006) here: http://housing.mcmaster.ca/Residence_Admissions/Buildings/lesprince.html.
- Les Prince Hall features single (single bed) or double (two single beds) occupancy guest rooms with a desk, bureau, and ensuite washroom. Bed linens, towel, face cloth and soap are provided. In addition, each guest room is equipped with a Wi-Fi internet connection. For those who prefer to plug in, an RJ-45 cable is required to connect to the network. A limited number of RJ-45 cables are available upon check-in. Guest MACIDS (to access the wireless) will be provided to each guest upon check-in and/or at Registration. See end of this document for a drawing of the room layouts.

- This year the CCNBB will pay for accommodation for 2 people from each local brain bee.
- Some of our competitors are travelling from distant locations and may need to stay extra nights. We will gather travel information through an online survey (link available at <http://brainbee.ca/students/preparing-for-the-national/>) and we can make special arrangement if you need additional rooms/nights. We will pay for accommodation for 2 people from each local brain bee for the nights needed.
- If you will be bringing additional family members we can arrange for them to stay in Les Prince Residences (use the online survey to tell us). We will work with you to collect payment for the additional people (approximately \$70 per night per person).
- When you arrive at McMaster, you will check in at the Housing & Conference Service Centre in the Commons Building which is open 24 hours. Campus maps with driving and walking directions:
 - <http://brainbee.ca/students/directions-and-maps/>
- Check-in time is 4pm and check-out time is 10:00am.
- You will be very busy on Saturday, so if you are not staying over Saturday night it would be a good idea to check out after breakfast. Luggage can be stored at the check in location in the Commons Building, or alternatively we can store luggage in the Psychology Building.

Travel

- If possible, plan to arrive on Friday by 3pm. Check in time at the residences is 4pm and we have lab tours beginning at 4pm. **Dinner will be served in the Psychology Building at 6pm.** The events should be finished by 4:30pm on Saturday.
- For those traveling from distant locations, you can fly into Hamilton International Airport or Toronto Pearson International Airport. For those coming from the airport, directions to McMaster and various maps can be found here:
 - <http://www.mcmaster.ca/welcome/findus.cfm>.
 - http://www.mcmaster.ca/welcome/images/campus_map.pdf.
- Campus maps showing driving directions through campus to the Commons Building, the location of campus buildings you will be visiting, and walking directions from residences to the Psychology Building: <http://brainbee.ca/students/directions-and-maps/>

Food

- Visitors will experience an authentic undergraduate university experience, staying in residence and eating breakfast in the Commons Marketplace in the Commons Building. The CCNBB will cover the cost of Friday dinner, Saturday breakfast, and Saturday lunch to all brain bee visitors.
- **Friday Arrival:** Coffee and cookies will be available at 4:00 pm (Psych 205)
- **Friday Dinner: 6:00 pm (Psych 205).**
- **Saturday Breakfast:** 7:00 to 8:15 am. A hot breakfast buffet is available at “al Centro” in the Commons Building (where you registered), at 7:00 am on Saturday morning. You need to arrive at the Psychology Building (Psych 205) by 8:30 am. The walk across campus will take about 15 minutes, so plan to be finished with breakfast in lots of time, especially if you are checking out after breakfast (see below for check-in and out details).
- **Saturday Lunch:** 11:30 am (Psych 205).
- **Other meals:** If you are staying longer, you can pay cash at the Commons Building buffet (check with them for meal times), or visit a local restaurant. Ask us if you would like some suggestions!

Schedule of Events

Friday

Arrival of Contestants

- Check in at Housing & Conference Service Centre in the Commons Building is 4pm (if you arrive before your room is ready, they will store your luggage for you). The registration desk is open 24 hours; they will direct you to Les Prince Hall (building 53). At check-in you can collect your parking permits and MacID for internet access. Please make sure when you check in that you receive the items you need. Contact us if you have any questions (see contact numbers on the first page of this document; don't hesitate to phone from the check-in desk at the residences if there are any problems).

4:00pm Psychology Building

- Orientation, introductions, lab tours: meet on the second floor, room 205
 - Take elevators to 2nd floor, turn right, and immediately right again. Psych 205 is the lounge area with floor to ceiling windows and outdoor balconies along both sides.

6:00pm Psychology Building

- Dinner at approximately 6:00pm (Psych 205).
- Back to the residences for a good night's sleep!

Saturday Morning

7:00 - 8:15am Breakfast buffet

- A hot breakfast will be served in the Commons Marketplace.
- Buffet will be open 7:00 to 8:30 am.
- Please try to finish breakfast as early as possible so that you will have time to check out (if necessary) and walk across campus to the Psychology Building by 8:30am (about a 15 minute walk).

8:30am Competition Starts

- Meet in the Psychology Building lobby.
- Competitors will receive lab coats, clipboards, and other materials required for the competition.
- Unfortunately, family members and other visitors cannot observe the neuroanatomy bell-ringer or patient diagnosis tests. You are free to relax in room 205 of the Psychology building, or explore campus on your own.

9:00am Neuroanatomy Bell-ringer

- Education Program in Anatomy, Health Sciences Centre

- The neuroanatomy bell-ringer competition consists of approximately 20 or 25 stations where brains, brain slices, or pictures of brains will be presented. Please see our web site (<http://brainbee.ca/students/preparing-for-the-national/>) for more details about the format of this test and how to prepare.

10:15am Patient Diagnosis

- The Centre for Simulation-Based Learning (CSBL), Health Sciences Centre. In 2015 we may use a temporary “clinic” in the Psychology building instead; rooms TBA, you will have a guide.
- There will be Standardized Patients who are professionally trained to portray neurological disorders. Please see our web site (<http://brainbee.ca/students/preparing-for-the-national/>) for more details about the format of this test and how to prepare.

11:30am Lunch

- A hot buffet lunch will be served (Psych 205). All brain bee competitors, all the brain bee guests, and all of the brain bee volunteers are welcome to join us for lunch.

Saturday Afternoon

All afternoon events will take place in room 155, Psychology Building

1:00pm Introductions

- Please be in room 155 by 1:00 pm sharp! Brain Bee competitors will be introduced, and group photos will taken at the front at this time. We will also do more photos during the awards ceremony at the end of the competition. There will be Introductory remarks by the organizers and by the CIHR representative. We will introduce the volunteers and the competition judges.

PLEASE NOTE: the details of the afternoon competition and the format of the rounds may change. The following describes what we did last year (2015). The 2016 competition will be similar but some of the details of the rounds may change. We will update this section once the details have been finalized.

1:30 pm Oral Competition

- This part of the competition will take place over several successive phases. All questions will come from "Neuroscience: Science of the Brain", published by the European Dana Alliance for the Brain and from "Neuroscience: Exploring the Brain, chapters 7, 7A, 15, and 22 (Bear, Connors & Paradiso, 3rd Edition). Download these documents from our website: <http://brainbee.ca/students/preparing-for-the-national/>

Phase 1: Open Multiple Choice - Speed Round

- All competitors compete in this phase; there will be **50 multiple choice questions**.
- The questions will be presented on the screen one at a time. Each question will be read aloud and the competitors will have THREE seconds to select their response using iClickers.

Phase 2: Open Multiple Choice - Challenge Round

- All competitors compete in this phase; there will be **15 multiple choice questions**.
- The questions will be presented on the screen one at a time. Each question will be read aloud and the competitors will have TEN seconds to select their response using iClickers.

Phase 3: Open Written

- All competitors compete in this phase; there will be **25 short-answer questions**.
- Each free-response question will be read aloud and the competitors will have TEN seconds to write down their response. All competitors will hold their responses up to be scored.

Short Break

- Scores from the open multiple choice phase and the open written phase will be combined with the scores from the morning competitions to determine who will advance further. In the event of a tie, a tie-breaker will consist of written answers to a long answer question which will be graded anonymously by the two neuroscience judges.

Phase 4: Final Showdown

- The third place winner is announced.
- The top two competitors face off to become CIHR Canadian National Brain Bee champion!
- Oral rounds of questions (competitors answer at the microphone).
 - There will be 40 questions total, presented in 4 rounds of 10 questions.
 - Both competitors get the same questions.
 - One competitor leaves the room while the other answers the questions.
 - The questions will be read aloud and SEVEN seconds will be given to produce an oral response.
- In the event of a tie:
 - The entire day's performance will be used to determine a winner.
 - In the unlikely event that a winner is still not decided, a tie-breaker will consist of written answers to a long answer question which will be graded anonymously by the two neuroscience judges.

4:00 pm Awards Ceremony

- Prizes and trophies will be awarded
- Congratulations from PNB, McMaster, and CIHR representatives
- Please remain for group photos.



We gratefully acknowledge the following groups for their support

We are supported nationally by
CIHR-Institute of Neurosciences, Mental Health and Addiction
<http://www.cihr-irsc.gc.ca/e/8602.html>

With additional support from

Faculty of Science, McMaster University

<http://www.science.mcmaster.ca/>

Department of Psychology, Neuroscience & Behaviour (PNB)

<http://www.science.mcmaster.ca/Psychology/>

The Science Media Lab at McMaster

<http://www.smlab.ca/>

The Centre for Simulation-Based Learning (CSBL), McMaster University

<http://simulation.mcmaster.ca/>

Educational Program in Anatomy, McMaster University

<http://fhs.mcmaster.ca/anatomy/index.html>

In addition, the Local Brain Bees across Canada are supported by their local institutions.

If you would like to support the CIHR Canadian National Brain Bee
or any of our local brain bees across Canada, please let us know!



Inspiring Innovation and Discovery



LES PRINCE HALL

Features:

- * Ensuite washroom in each room
- * 2 common areas with kitchenette per floor
- * Air conditioned
- * High-speed internet service
- * Parking close to residence

Double with Washroom

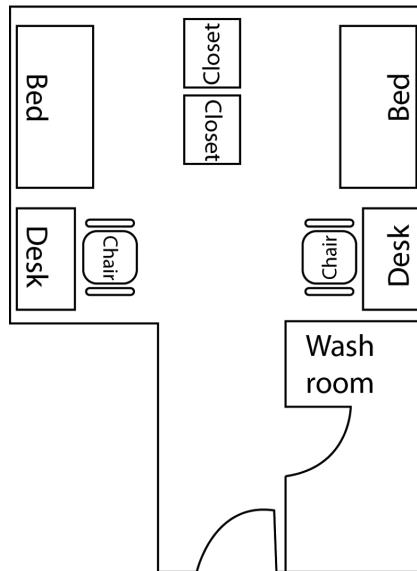

Single with Washroom

